

# Adding a Course Image

## Creating a Branded Space (Banner)

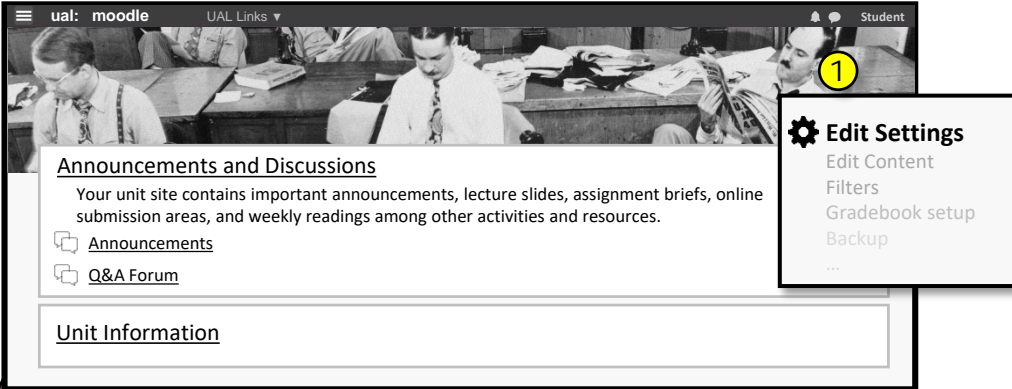

ual: moodle UAL Links Student

**1**

**Edit Settings**

- Edit Content
- Filters
- Gradebook setup
- Backup
- ...

Announcements and Discussions

Your unit site contains important announcements, lecture slides, assignment briefs, online submission areas, and weekly readings among other activities and resources.

- Announcements
- Q&A Forum

Unit Information

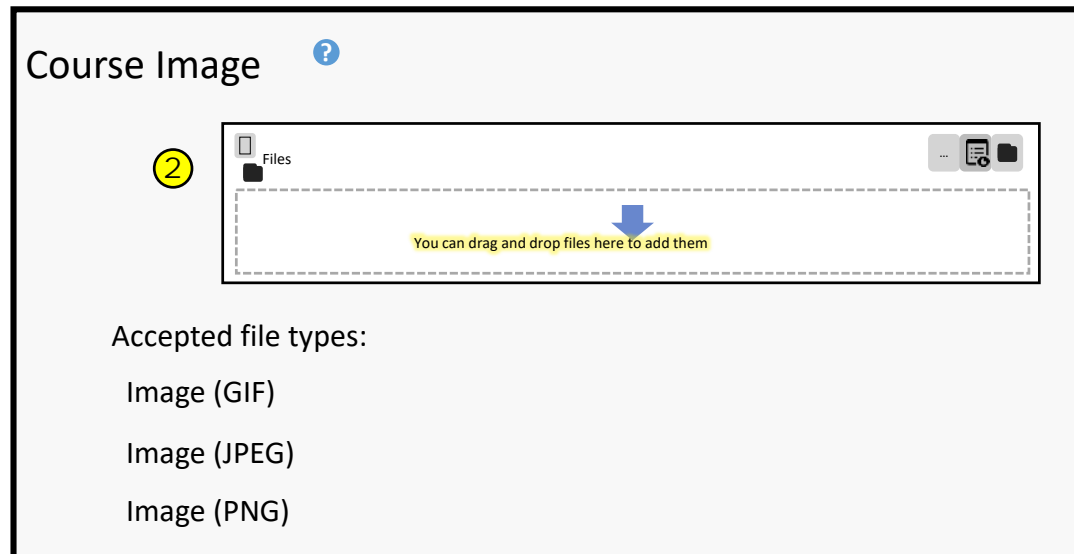

**2**

Course Image ?

Files

You can drag and drop files here to add them

Accepted file types:

- Image (GIF)
- Image (JPEG)
- Image (PNG)

### TECHNICAL

Select **(1) Edit Settings** and upload a pre-selected image as your **(2) Course image**.

### Image Files

Images should be a GIF or JPG, approximately 600px by 300px, and text free. Patterns, textures, and colours are best.

# Adding Topic Thumbnails

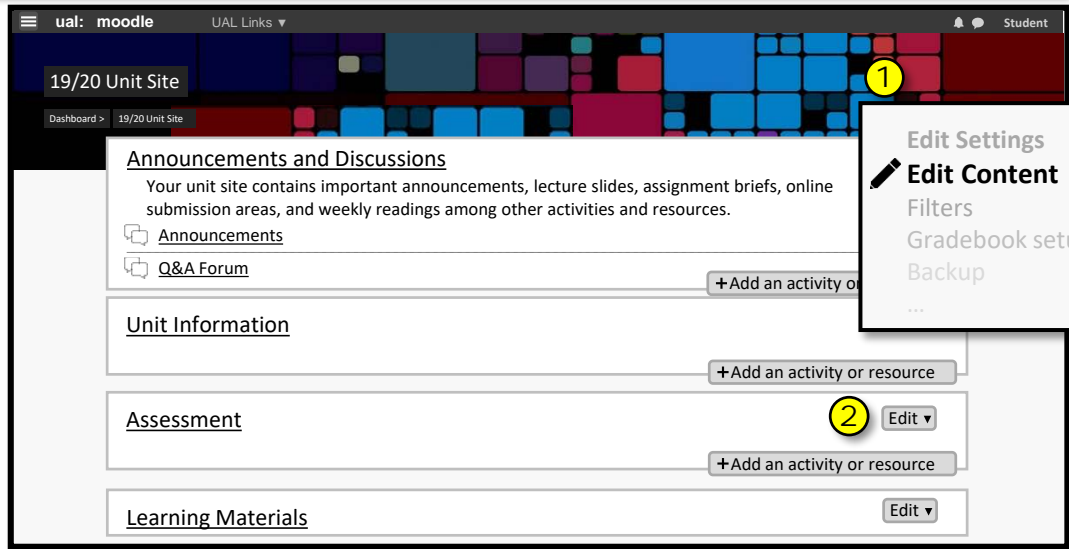

Select (1) **Edit Content**, choose a topic area and select (2) **Edit**.

Find and click the (3) **Image icon** in the text editor then (4) **Find or upload an image...**

Under **Upload a file** select (5) **Choose file**, add your image, then press (6) **Upload this file**.

Lastly, select the **Appearance** tab, set alignment to (7) **Left**, dimension to (8) **60x60**, and press (9) **Insert**.

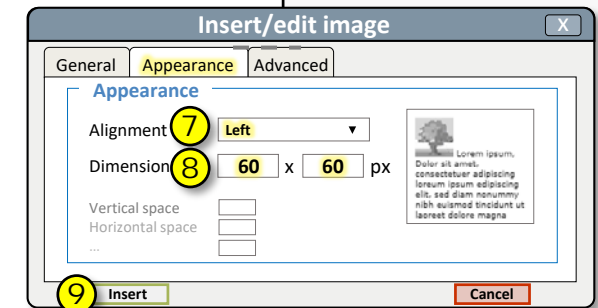
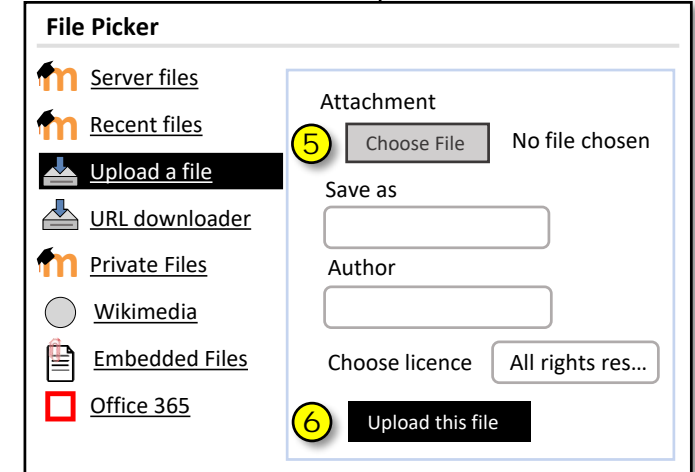
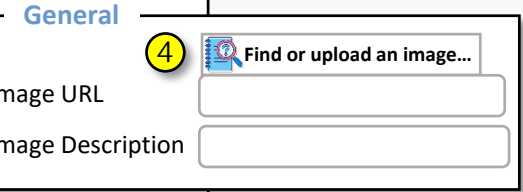

## Example Thumbnails

Zip file available under  
*LCC Moodle Guides for Tutors* on the **LCC Teaching Hub**